

# AMERICAN MOTORS PARTS CATALOG

## GROUP 9 REAR AXLE - PROP SHAFT

DESCRIPTION	GROUP AND FIGURE NO.	GROUP NO.
ADAPTER, Torque Tube .....	9-5, 6-2, 6-5, 6-6 .....	9.156
AXLE, Rear .....	9-1 .....	9.001
BEARING, Rear Axle Differential Side .....	9-1 .....	9.041
BEARING, Rear Axle Drive Shaft .....	9-1 .....	9.073
BEARING, Rear Axle Pinion .....	9-1 .....	9.052
BEARING KIT, Propeller Shaft Center .....	.....	9.144
BLOCK, Rear Axle Differential Pinion Shaft Thrust .....	9-1, 9-2 .....	9.039
BRACKET, Rear Axle Sway Stabilizer .....	9-3 .....	9.089
BUMPER, Rear Axle .....	.....	9.086
CASE, Rear Axle Differential .....	9-1, 9-2 .....	9.024
CASE ASSEMBLY, Rear Axle Differential .....	9-1 .....	9.021
COVER, Rear Axle Housing .....	9-1 .....	9.007
CUP, Rear Axle Drive Shaft Bearing .....	9-1 .....	9.075
CUP, Rear Axle Differential Side Bearing .....	9-1 .....	9.043
CUP, Rear Axle Pinion Bearing .....	9-1 .....	9.055
COUPLING, Propeller Shaft .....	.....	9.101
CUSHION, Torque Tube to Adapter .....	9-5 .....	9.150
DISC, Rear Axle Differential Side Gear .....	9-2 .....	9.035
GEAR SET, Axle Ring .....	9-1 .....	9.050
GEAR SET, Rear Axle Differential Pinion .....	9-1, 9-2 .....	9.031
GEAR SET, Rear Axle Differential Side .....	9-1, 9-2 .....	9.027
HOUSING, Rear Axle .....	9-1 .....	9.003
JOINT, Universal .....	.....	9.105
NUT, Flange to Pinion .....	9-1 .....	9.080
PLATE, Rear Axle Differential Side Gear .....	9-2 .....	9.035
PLUG, Rear Axle Drain and Filler .....	9-1 .....	9.005
RETAINER, Rear Axle Drive Shaft Grease .....	.....	9.076
RETAINER, Torque Tube Rear Oil Seal .....	9-6 .....	9.152
RETAINER, Universal Joint Round Bearing .....	.....	9.118
RING, Rear Axle Differential Side Gear .....	9-2 .....	9.034
ROD, Rear Axle Truss .....	11-6 .....	9.134
SCREW, Rear Axle Differential Side Bearing Cap .....	9-1 .....	9.018
SCREW, Torque Tube Trunnion .....	9-5, 9-6 .....	9.148
SEAL, Rear Axle Drive Shaft Inner Oil .....	9-1 .....	9.072
SEAL, Rear Axle Drive Shaft Outer Oil .....	.....	9.077
SEAL, Rear Axle Pinion Oil .....	9-1 .....	9.064
SEAL, Torque Tube Rear Oil .....	9-6 .....	9.152
SEAL, Universal Joint Oil .....	6-2, 6-6 .....	9.160
SHAFT, Propeller .....	9-4 .....	9.100
SHAFT, Rear Axle Differential .....	9-1, 9-2 .....	9.036
SHAFT, Rear Axle Drive .....	9-1 .....	9.068
SHIM, Rear Axle Differential Side Bearing .....	9-1 .....	9.045
SHIM, Rear Axle Pinion Adjusting .....	9-1 .....	9.057
SHIM, Rear Axle Pinion Shaft Bearing .....	9-1 .....	9.062
SPIDER, Universal Joint .....	9-4 .....	9.107
STABILIZER, Rear Axle Sway .....	9-3 .....	9.090
STUD, Torque Tube Trunnion .....	9-5, 9-6 .....	9.148
TRUNNION, Torque Tube .....	9-5 .....	9.146
TUBE, Torque .....	9-5, 9-6 .....	9.140
WASHER, Rear Axle Differential Side Gear Thrust .....	9-1 .....	9.029
WASHER, Universal Joint Bearing Cork .....	.....	9.112
WASHER, Rear Axle Differential Pinion Gear Thrust .....	9-1 .....	9.033
YOKE, Universal Joint .....	9-4 .....	9.104



# AMERICAN MOTORS PARTS CATALOG

## GROUP 9 REAR AXLE - PROP SHAFT

DESCRIPTION	GROUP AND FIGURE NO.	GROUP NO.
ADAPTER, Torque Tube .....	9-5, 6-2, 6-5, 6-6 .....	9.156
AXLE, Rear .....	9-1 .....	9.001
BEARING, Rear Axle Differential Side .....	9-1 .....	9.041
BEARING, Rear Axle Drive Shaft .....	9-1 .....	9.073
BEARING, Rear Axle Pinion .....	9-1 .....	9.052
BEARING KIT, Propeller Shaft Center .....	.....	9.144
BLOCK, Rear Axle Differential Pinion Shaft Thrust .....	9-1, 9-1A, 9-2 .....	9.039
BRACKET, Rear Axle Sway Stabilizer .....	9-3 .....	9.089
BUMPER, Rear Axle .....	.....	9.086
CASE, Rear Axle Differential .....	9-1, 9-1A, 9-2 .....	9.024
CASE ASSEMBLY, Rear Axle Differential .....	9-1, 9-1A, 9-2 .....	9.021
COVER, Rear Axle Housing .....	9-1 .....	9.007
CUP, Rear Axle Drive Shaft Bearing .....	9-1 .....	9.075
CUP, Rear Axle Differential Side Bearing .....	9-1 .....	9.043
CUP, Rear Axle Pinion Bearing .....	9-1 .....	9.055
COUPLING, Propeller Shaft .....	.....	9.101
CUSHION, Torque Tube to Adapter .....	9-5 .....	9.150
DISC, Rear Axle Differential Side Gear .....	9-2 .....	9.035
GASKET, Rear Axle Housing Cover .....	9-1 .....	9.007
GASKET, Rear Axle Pinion Oil Seal Retainer .....	9-1 .....	9.064
GEAR SET, Axle Ring .....	9-1 .....	9.050
GEAR SET, Rear Axle Differential Pinion .....	9-1, 9-1A, 9-2 .....	9.031
GEAR SET, Rear Axle Differential Side .....	9-1, 9-1A, 9-2 .....	9.027
HOUSING, Rear Axle .....	9-1 .....	9.003
JOINT, Universal .....	.....	9.105
NUT, Flange to Pinion .....	9-1 .....	9.050
PLATE, Rear Axle Differential Side Gear .....	9-2 .....	9.035
PLUG, Rear Axle Drain and Filler .....	9-1 .....	9.005
RETAINER, Rear Axle Drive Shaft Grease .....	.....	9.076
RETAINER, Rear Axle Pinion Oil Seal .....	9-1 .....	9.064
RETAINER, Torque Tube Rear Oil Seal .....	9-6 .....	9.152
RETAINER, Universal Joint Round Bearing .....	.....	9.118
RING, Rear Axle Differential Side Gear .....	9-2 .....	9.034
ROD, Rear Axle Truss .....	11-6 .....	9.134
SCREW, Rear Axle Differential Side Bearing Cap .....	9-1 .....	9.018
SCREW, Torque Tube Trunnion .....	9-5, 9-6 .....	9.148
SEAL, Rear Axle Drive Shaft Inner Oil .....	9-1 .....	9.072
SEAL, Rear Axle Drive Shaft Outer Oil .....	.....	9.077
SEAL, Rear Axle Pinion Oil .....	9-1 .....	9.064
SEAL, Torque Tube Rear Oil .....	9-6 .....	9.152
SEAL, Universal Joint Oil .....	6-2, 6-6 .....	9.160
SHAFT, Propeller .....	9-4 .....	9.100
SHAFT, Rear Axle Differential .....	9-1, 9-1A, 9-2 .....	9.036
SHAFT, Rear Axle Drive .....	9-1 .....	9.068
SHIM, Rear Axle Differential Side Bearing .....	9-1 .....	9.045
SHIM, Rear Axle Pinion Adjusting .....	9-1 .....	9.057
SHIM, Rear Axle Pinion Shaft Bearing .....	9-1 .....	9.062
SPIDER, Universal Joint .....	9-4 .....	9.107
SPRING KIT, Rear Axle Differential Preload .....	9-1A .....	9.038
STABILIZER, Rear Axle Sway .....	9-3 .....	9.090
STUD, Torque Tube Trunnion .....	9-5, 9-6 .....	9.148
TRUNNION, Torque Tube .....	9-5 .....	9.146
TUBE, Torque .....	9-5, 9-6 .....	9.140
WASHER, Rear Axle Differential Side Gear Thrust .....	9-1 .....	9.029
WASHER, Universal Joint Bearing Cork .....	.....	9.112
WASHER, Rear Axle Differential Pinion Gear Thrust .....	9-1, 9-1A .....	9.033
YOKE, Universal Joint .....	9-4 .....	9.104



# AMERICAN MOTORS PARTS CATALOG

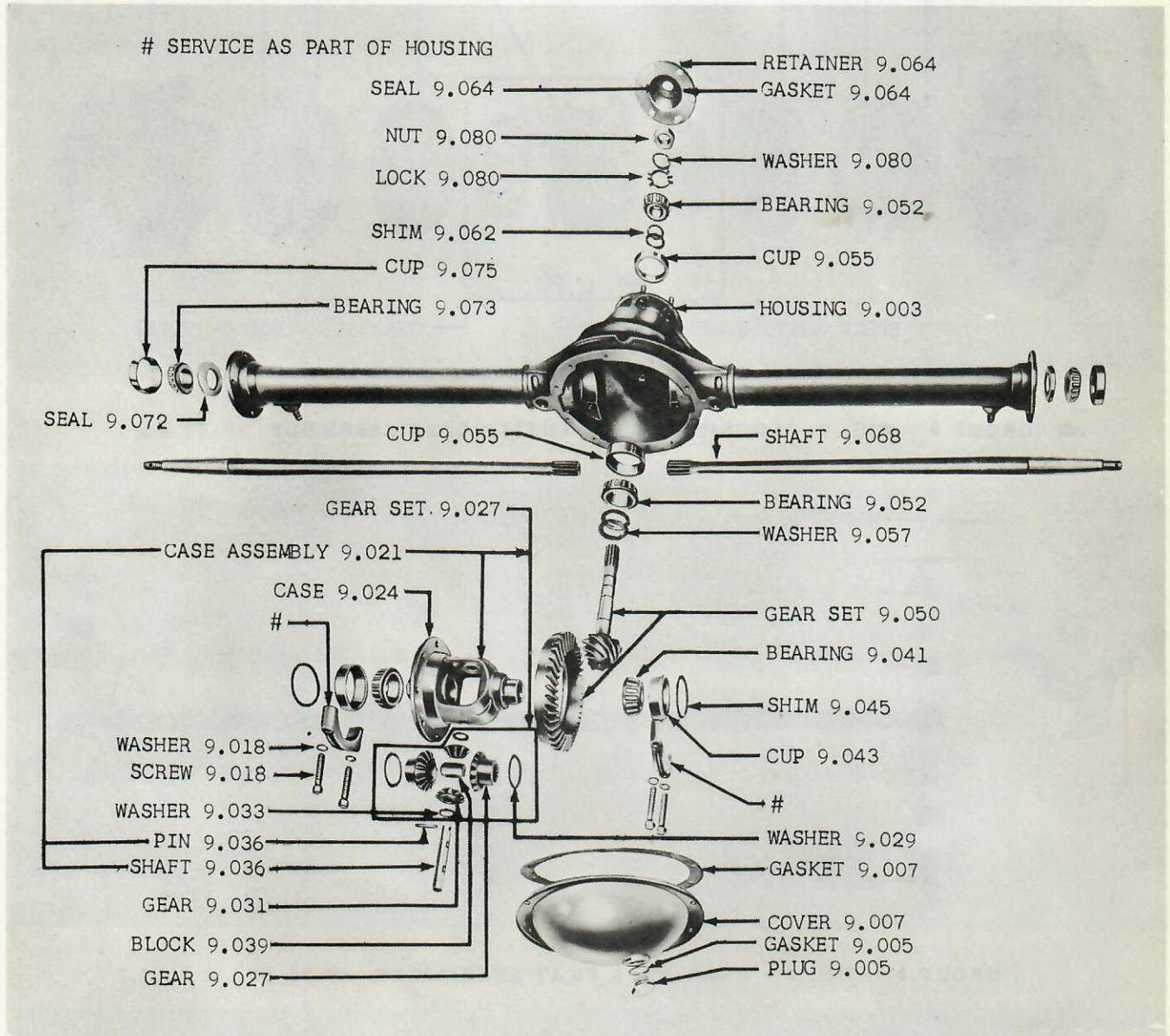

GROUP 9 - FIG. 1 - REAR AXLE 01-10-20-80



# AMERICAN MOTORS PARTS CATALOG

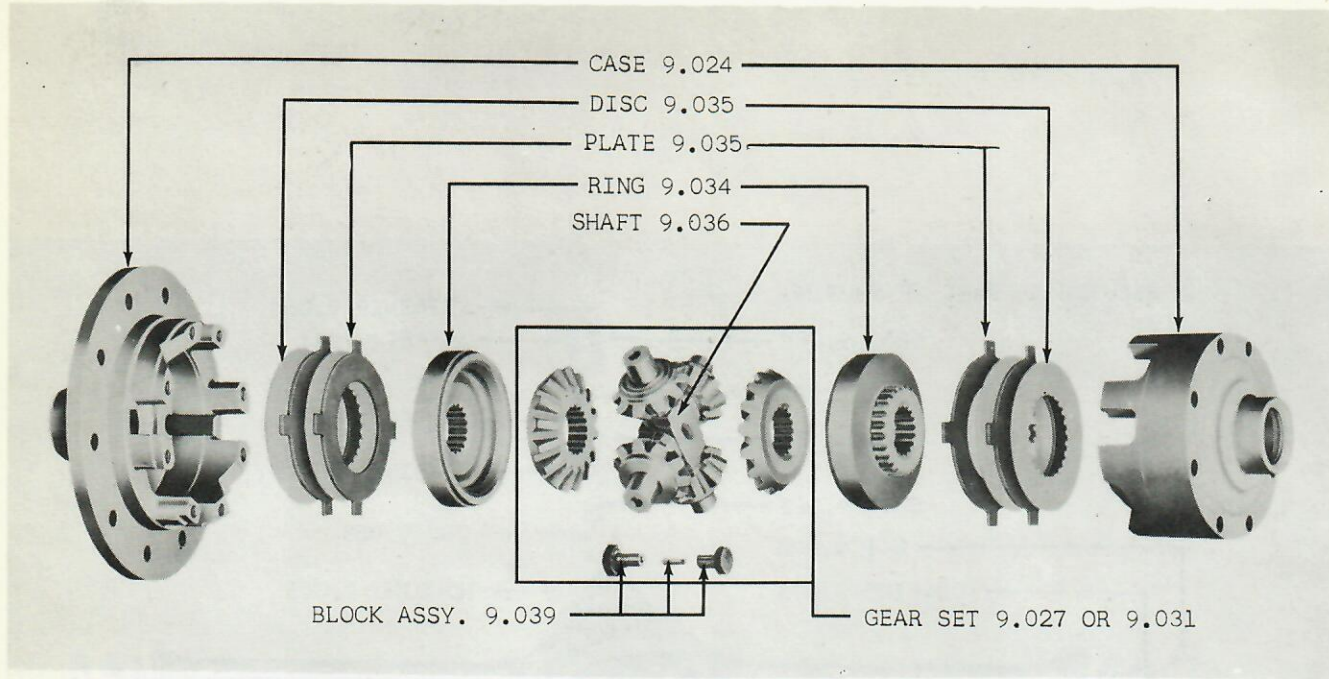

GROUP 9 - FIG. 2 - LOCKING DIFFERENTIAL CASE ASSEMBLY 20-80

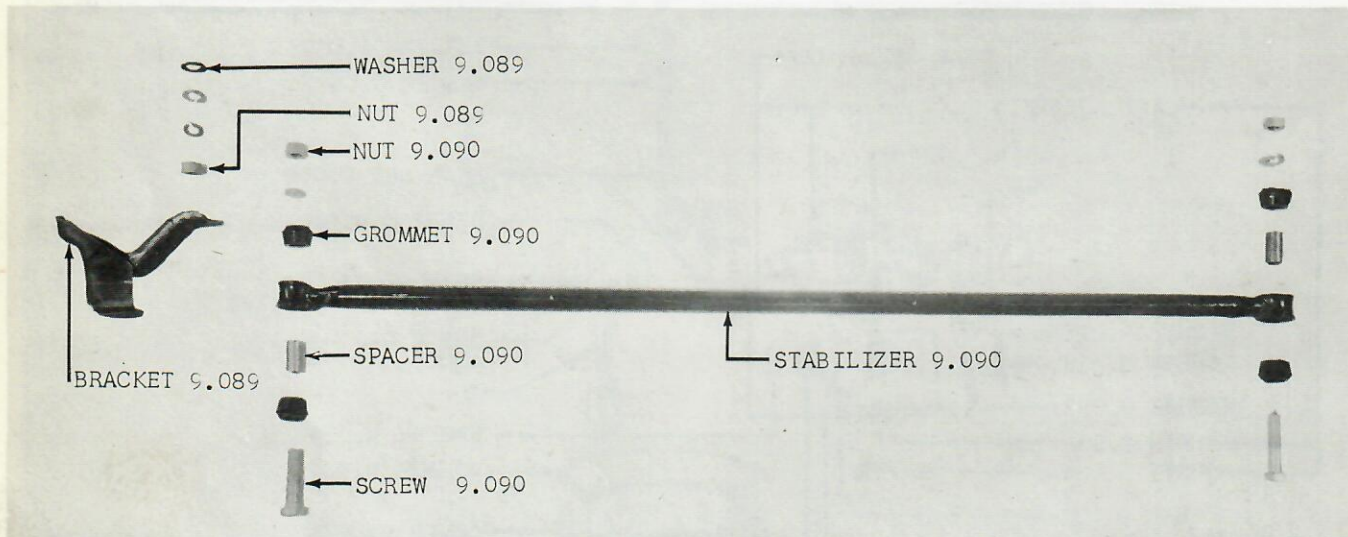

GROUP 9 - FIG. 3 - REAR AXLE SWAY STABILIZER 10-20-80

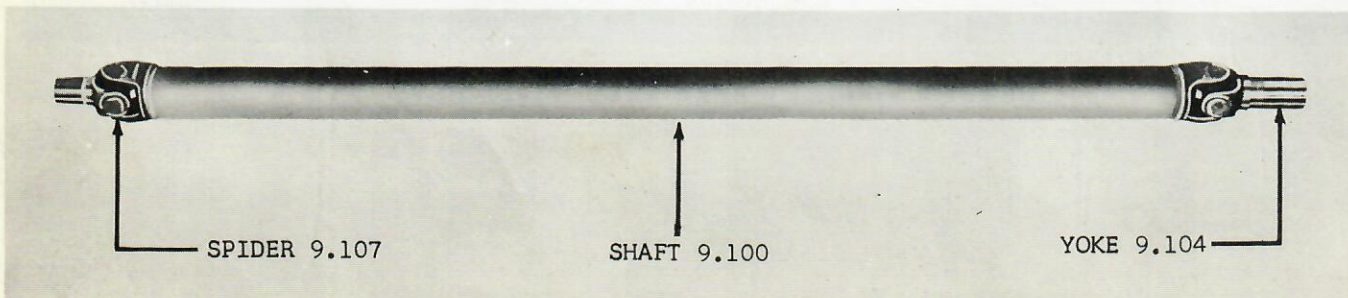

GROUP 9 - FIG. 4 - PROPELLER SHAFT 01



# AMERICAN MOTORS PARTS CATALOG

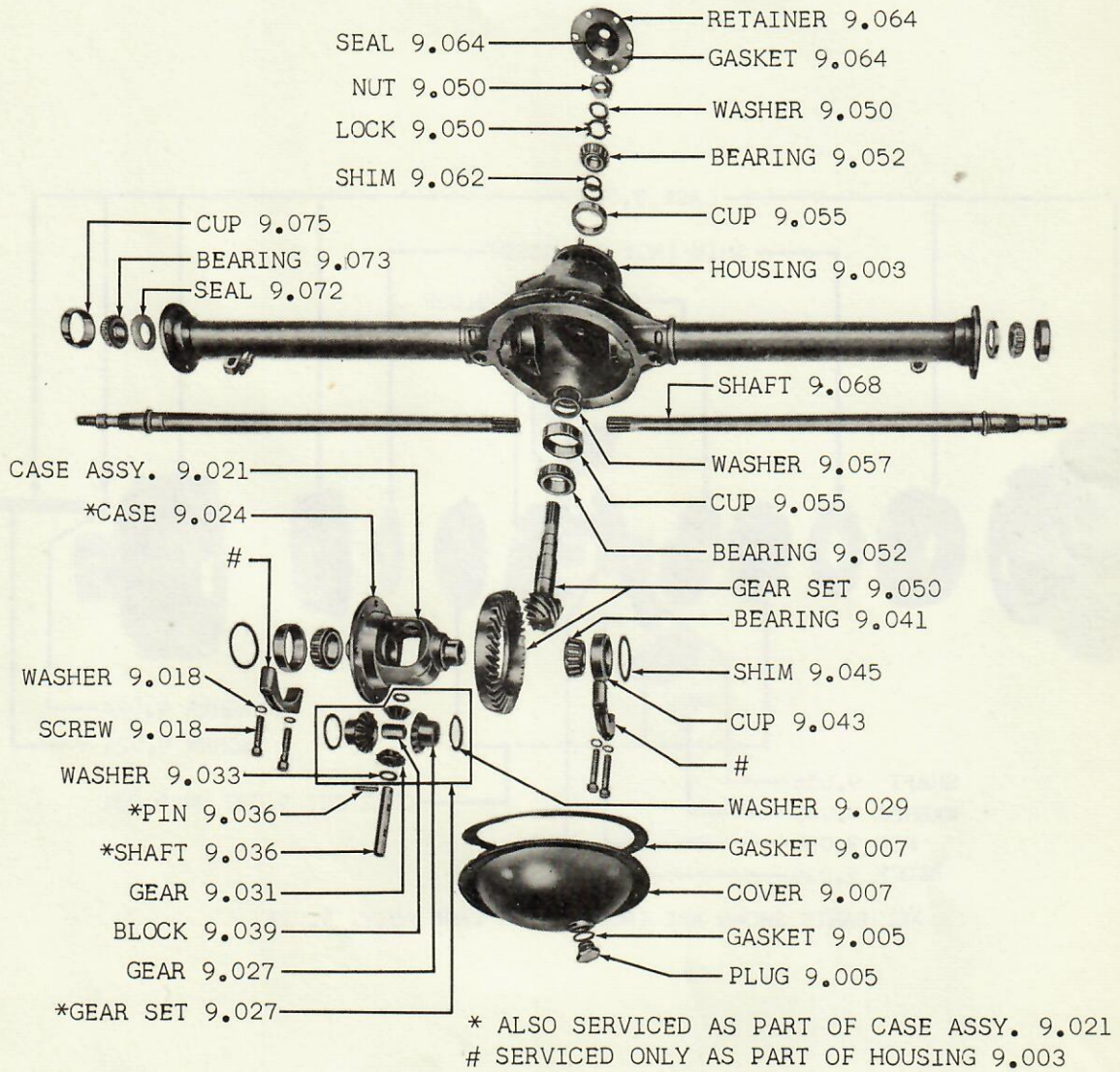

GROUP 9 - FIG. 1 REAR AXLE 01-10-20-80



# AMERICAN MOTORS PARTS CATALOG

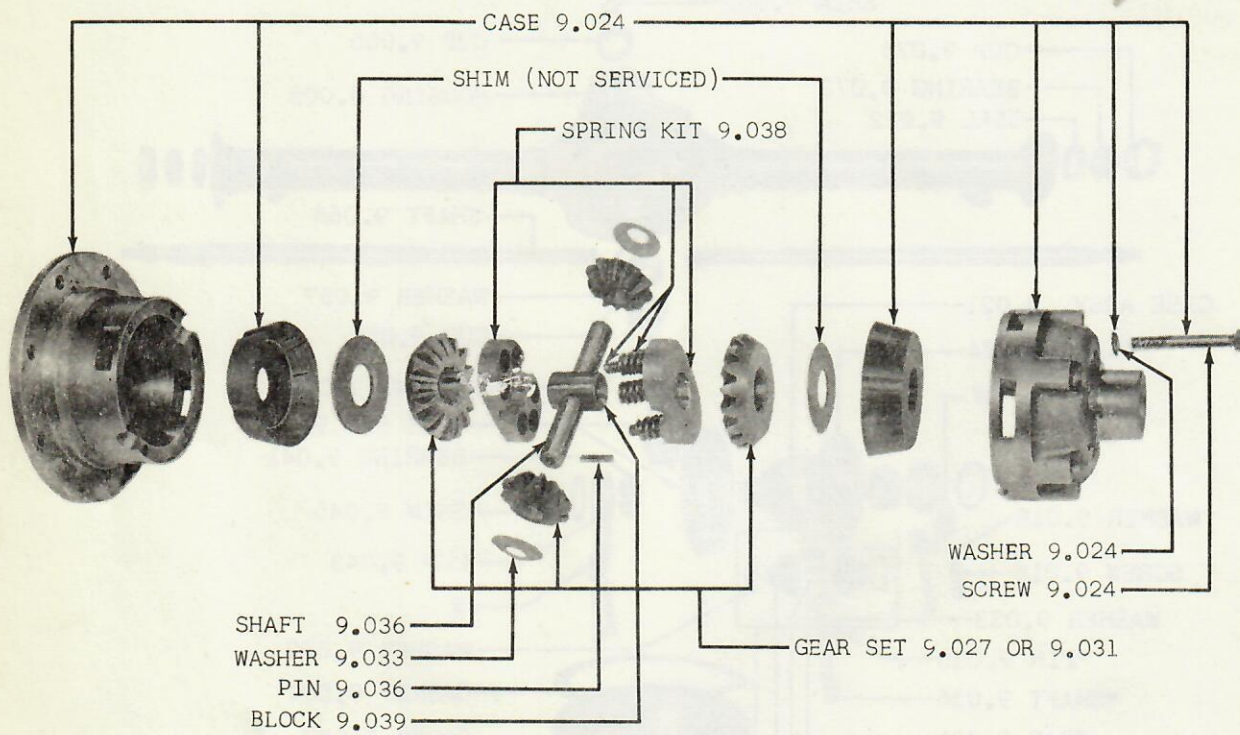

ALL PARTS SHOWN ARE INCLUDED IN CASE ASSY. 9.021

GROUP 9 - FIG. 1A LOCKING DIFFERENTIAL CASE ASSEMBLY 01-10 (WLD)



# AMERICAN MOTORS PARTS CATALOG

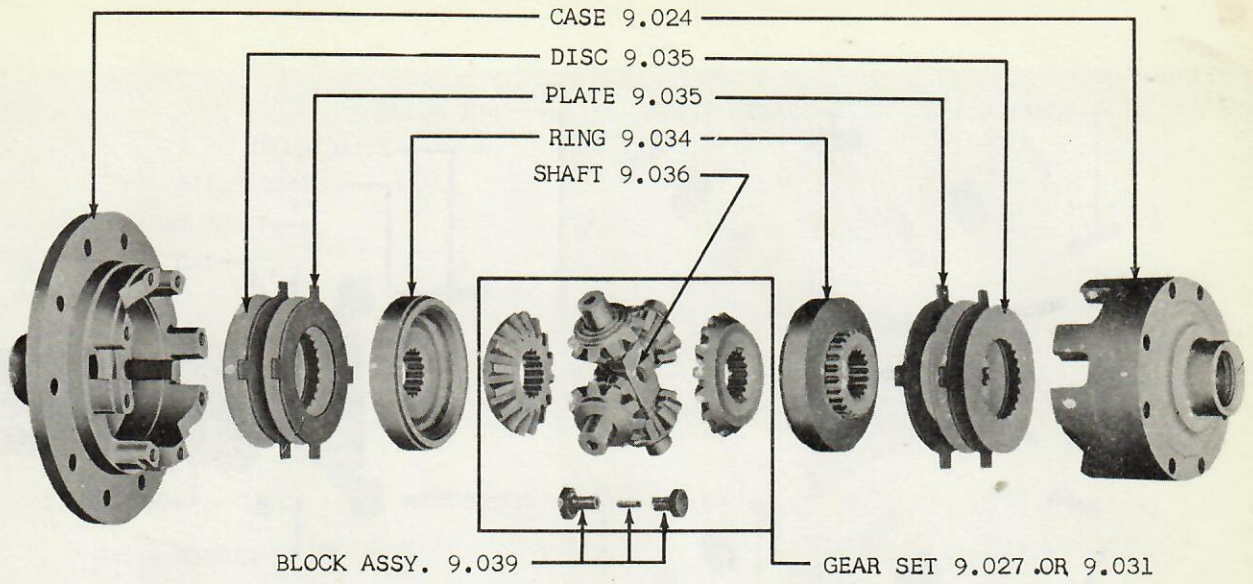

ALL PARTS SHOWN ARE INCLUDED IN CASE ASSY. 9.021

GROUP 9 - FIG. 2 - LOCKING DIFFERENTIAL CASE ASSEMBLY 20-80 (WLD)

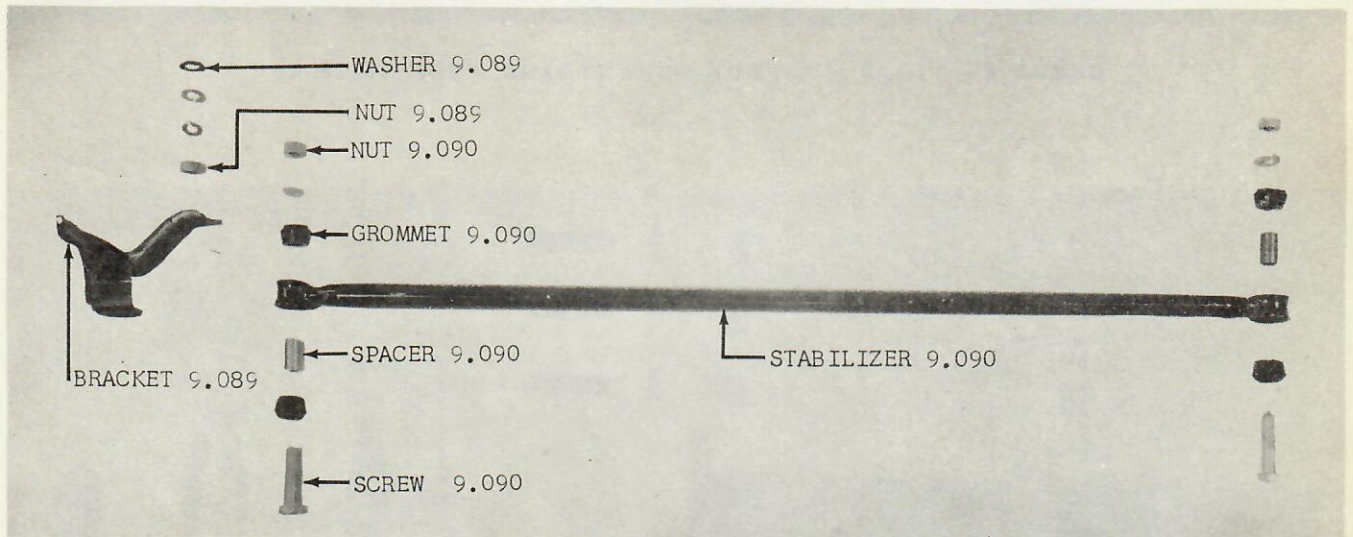

GROUP 9 - FIG. 3 - REAR AXLE SWAY STABILIZER 10-20-80

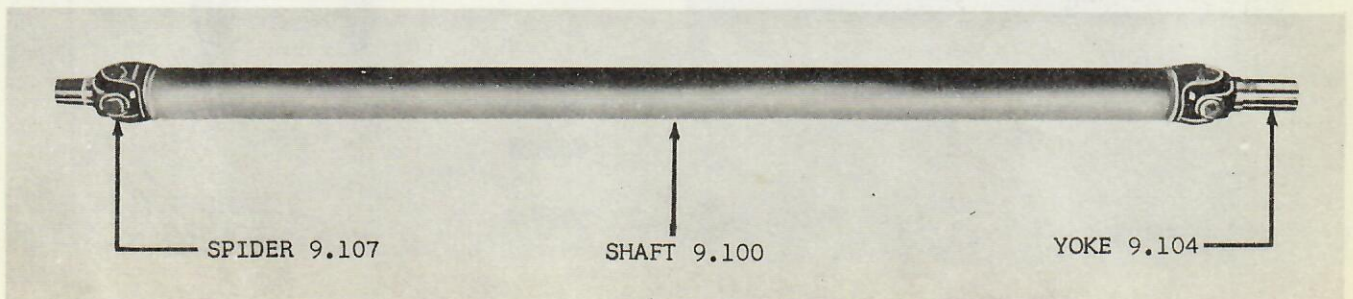

GROUP 9 - FIG. 4 - PROPELLER SHAFT 01



# AMERICAN MOTORS PARTS CATALOG

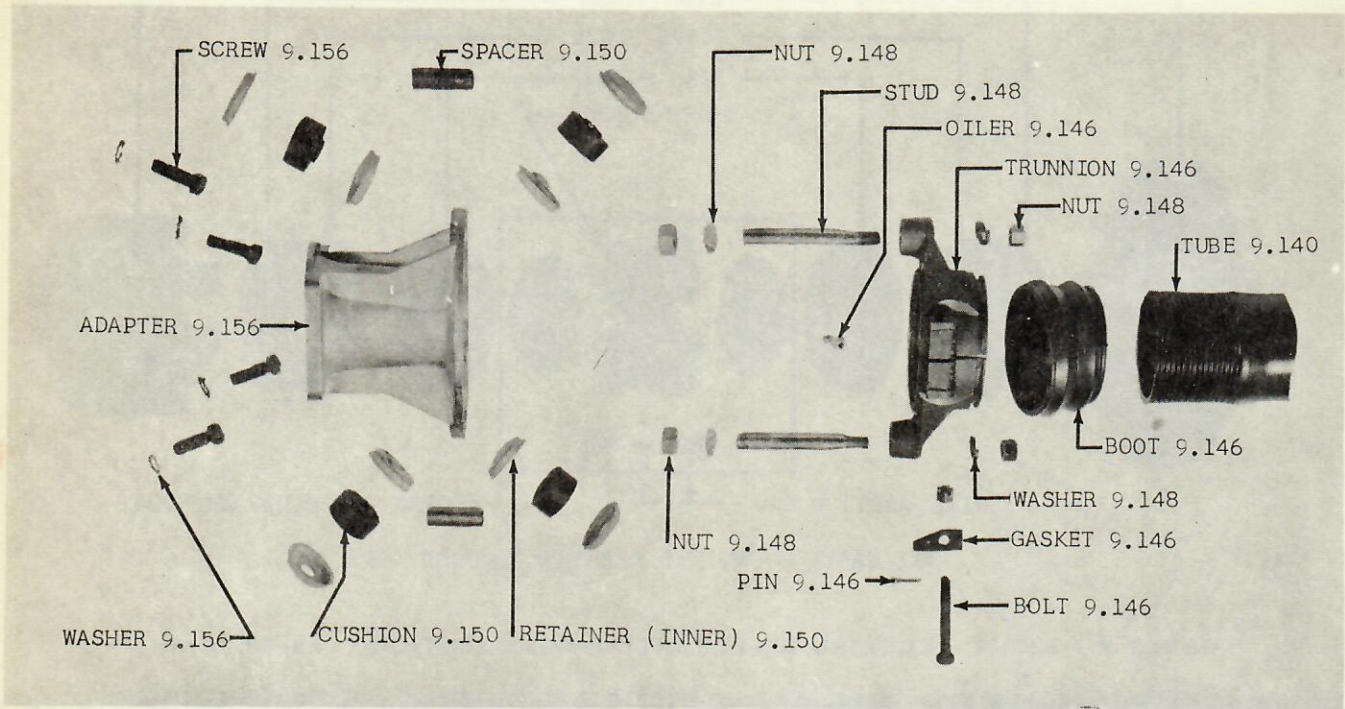

GROUP 9 - FIG. 5 - TORQUE TUBE (TRANS. END) 10-20-80

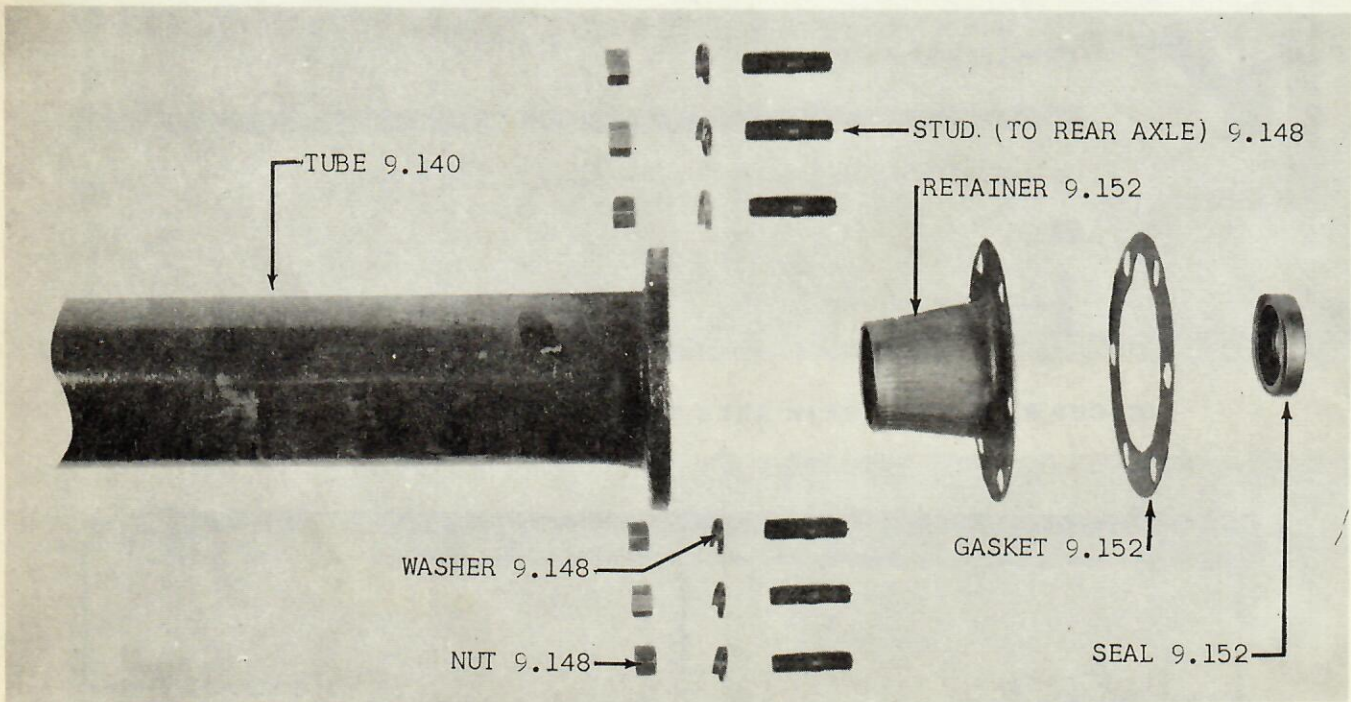

GROUP 9 - FIG. 6 - TORQUE TUBE (AXLE END) 10-20-80



# AMERICAN MOTORS PARTS CATALOG

9.005

DESCRIPTION	YEAR AND MODEL	PER CAR	PART NO.
-------------	----------------	---------	----------

## GROUP 9 REAR AXLE - PROP SHAFT

### 9.001 AXLE, Rear

AXLE (Less Shafts)(13/43 Ratio).....	59 01 (LLD-WST)(LLD-WAT).....	1	320 0902
	59 01 (WLD-WST)(WLD-WAT).....	1	320 1526
	59 10 (LLD-WAT).....	1	320 0522
	59 10 (WLD-WAT).....	1	320 1530
(9/34 Ratio).....	59 01 (LLD-WST)(LLD-WOD).....	1	320 0900
	59 01 (WLD-WST)(WLD-WOD).....	1	320 1525
	59 10 (LLD-WST)(LLD-WAT).....	1	320 0520
	59 10 (WLD-WST)(WLD-WAT).....	1	320 1528
(9/37 Ratio).....	59 01 (LLD-WOD).....	1	320 0901
	59 01 (WLD-WOD).....	1	320 1527
	59 10 (LLD-WST)(LLD-WOD).....	1	320 1396
	59 10 (WLD-WST)(WLD-WOD).....	1	320 1529
(8/35 Ratio).....	59 10 (LLD-WST)(LLD-WOD).....	1	320 0521
	59 10 (WLD-WST)(WLD-WOD).....	1	320 1531
(10/41 Ratio).....	59 20 (LLD-WST)(LLD-WOD).....	1	320 1182
	59 20 (WLD-WST)(WLD-WOD).....	1	320 1185
	59 80 (LLD-WST)(LLD-WOD).....	1	320 1192
	59 80 (WLD-WST)(WLD-WOD).....	1	320 1194
(9/40 Ratio).....	59 20 (LLD-WST)(LLD-WOD).....	1	320 1181
	59 20 (WLD-WST)(WLD-WOD).....	1	320 1184
(13/41 Ratio).....	59 20 (LLD-WAT).....	1	320 1400
	59 20 (WLD-WAT).....	1	320 1402
	59 80 (LLD-WAT).....	1	320 1193
	59 80 (WLD-WAT).....	1	320 1195
(11/39 Ratio).....	59 20 (LLD-WAT).....	1	320 1183
	59 20 (WLD-WAT).....	1	320 1186
	59 80 (LLD-WST)(LLD-WOD).....	1	320 1404
	59 80 (WLD-WST)(WLD-WOD).....	1	320 1406
(15/43 Ratio).....	59 80 (LLD-WAT).....	1	320 1445
LUBRICANT, Locking Differential (1 Quart).....	59 01-10 (WLD).....	AR	320 1558
	59 20-80 (WLD).....	AR	320 1017

### 9.003 HOUSING, Rear Axle

HOUSING (Incl. Tubes).....	59 01.....	1	320 0903
	59 10.....	1	320 0523
	59 20.....	1	320 1180
	59 80.....	1	320 1191
STUD, To Torque Tube.....	59 10-20-80.....	6	312 1398
WASHER (Lock), To Torque Tube Stud.....	59 10-20-80.....	6	G103328
NUT, To Torque Tube Stud.....	59 10-20-80.....	6	G103027
SCREW, Grease Hole.....	59 01-10-20-80.....	2	G145376

### 9.004 BUMPER, Rear Axle Housing

BUMPER.....	59 01.....	1	313 3687
SCREW.....	59 01.....	2	G455451
WASHER (Plain).....	59 01.....	2	800 0141

### 9.005 PLUG, Rear Axle Filler

PLUG.....	59 01-10-20-80.....	1	G445091
GASKET.....	59 01-10-20-80.....	1	314 6289



# AMERICAN MOTORS PARTS CATALOG

## 9.007 COVER, Rear Axle Housing

COVER (Incl. Plug And Gasket).....	59 01-10.....	1	311 9166
	59 20-80.....	1	311 9185
GASKET.....	59 01-10.....	1	310 5344
	59 20-80.....	1	98 537
SCREW.....	59 01.....	10	800 0061
(Long).....	59 10 (LAS)(2 Req.): 59 10 (WAS)(3 Req.)....	AR	800 0459
	59 20-80 (LAS)(2 Req.): 59 20-80 (WAS) (3 Req.).....	AR	G180121
(Short).....	59 10 (LAS)(8 Req.): 59 10 (WAS)(7 Req.)....	AR	800 0061
	59 20-80 (LAS)(8 Req.): 59 20-80 (WAS) (7 Req.).....	AR	G179835
WASHER (Lock), Screw.....	59 20-80.....	10	G103321

## 9.018 SCREW, Rear Axle Differential Side Bearing Cap

SCREW.....	59 01-10.....	4	22 620
	59 20-80.....	4	98 536

## 9.021 CASE ASSEMBLY, Rear Axle Differential

CASE ASSEMBLY.....	59 01-10 (LLD).....	1	314 2116
	59 01-10 (WLD).....	1	320 1576
	59 20 (LLD).....	1	313 4455
	59 20-80 (WLD).....	1	320 0816
(10/41, 13/41 And 11/39 Ratios)..	59 80 (LLD).....	1	313 4455
(15/43 Ratio).....	59 80 (LLD-WAT).....	1	315 6020

## 9.024 CASE, Rear Axle Differential

CASE.....	59 01-10 (LLD).....	1	314 1106
	59 01-10 (WLD).....	1	320 2183
	59 20 (LLD).....	1	313 4364
	59 20-80 (WLD).....	1	320 0817
(10/41, 13/41 And 11/39 Ratios).....	59 80 (LLD).....	1	313 4364
(15/43 Ratio).....	59 80 (LLD-WAT).....	1	315 6024
SCREW.....	59 01-10 (WLD).....	6	320 2191
	59 20-80 (WLD).....	8	320 0818

## 9.027 GEAR SET, Rear Axle Differential Side

GEAR SET.....	59 01-10 (LLD).....	1	311 8578
	59 01-10 (WLD).....	1	320 2184
	59 20-80 (LLD).....	1	311 1911
	59 20-80 (WLD).....	1	320 0815
GEAR.....	59 20-80 (LLD).....	2	312 1441

## 9.029 WASHER, Rear Axle Differential Side Gear Thrust

WASHER.....	59 01-10 (LLD).....	2	310 5325
	59 20-80 (LLD).....	2	87 048

## 9.031 GEAR SET, Rear Axle Differential Pinion

GEAR SET.....	59 01-10 (LLD).....	1	311 8578
	59 01-10 (WLD).....	1	320 2184
	59 20-80 (LLD).....	1	311 1911
	59 20-80 (WLD).....	1	320 0815
GEAR.....	59 20-80 (LLD).....	2	315 3597



# AMERICAN MOTORS PARTS CATALOG

9.045

## 9.033 WASHER, Rear Axle Differential Pinion Gear Thrust

WASHER.....	59 01-10 (LLD).....	2	314 1110
	59 01-10 (WLD).....	2	320 2190
	59 20-80 (LLD).....	2	87 044

## 9.034 RING, Rear Axle Differential Side Gear

RING.....	59 20-80 (WLD).....	2	320 0811
-----------	---------------------	---	----------

## 9.035 DISC-PLATE, Rear Axle Differential Clutch Friction

DISC.....	59 20-80 (WLD).....	4	320 0812
PLATE.....	59 20-80 (WLD).....	4	320 0813

## 9.036 SHAFT, Rear Axle Differential

SHAFT.....	59 01-10 (LLD).....	1	310 5323
	59 01-10 (WLD).....	1	320 2188
	59 20-80 (LLD).....	1	315 3596
	59 20-80 (WLD).....	1	320 0810
PIN.....	59 01-10-20-80 (LLD).....	1	315 3437
	59 01-10 (WLD).....	1	320 2189

## 9.038 SPRING KIT, Rear Axle Differential Preload

SPRING KIT.....	59 01-10 (WLD).....	1	320 2185
-----------------	---------------------	---	----------

## 9.039 BLOCK, Rear Axle Differential Pinion Shaft Thrust

BLOCK.....	59 01-10 (LLD).....	1	314 3482
	59 20-80 (LLD).....	1	28 281
BLOCK ASSEMBLY (Incl. Pin).....	59 20-80 (WLD).....	1	320 0814

## 9.041 BEARING, Rear Axle Differential Side

BEARING.....	59 01-10.....	2	310 5346
	59 20-80.....	2	98 557

## 9.043 CUP, Rear Axle Differential Side Bearing

CUP.....	59 01-10.....	2	310 5347
	59 20-80.....	2	98 556

## 9.045 SHIM, Rear Axle Differential Side Bearing

SHIM (.003).....	59 01-10.....	AR	311 2620
	59 20-80.....	AR	98 526
(.005).....	59 01-10.....	AR	311 2621
	59 20-80.....	AR	98 527
(.010).....	59 01-10.....	AR	311 2622
	59 20-80.....	AR	98 528
(.070).....	59 01-10.....	AR	311 6296
	59 20-80.....	AR	311 5306
(.072).....	59 01-10.....	AR	311 6297
	59 20-80.....	AR	311 5307
(.074).....	59 01-10.....	AR	311 6298
	59 20-80.....	AR	311 5308
(.076).....	59 01-10.....	AR	311 6299
	59 20-80.....	AR	311 5309



# AMERICAN MOTORS PARTS CATALOG

(.078).....	59 01-10.....	AR 311 6300
	59 20-80.....	AR 311 5310
(.080).....	59 01-10.....	AR 310 8472
	59 20-80.....	AR 311 4674
(.082).....	59 01-10.....	AR 311 2014
	59 20-80.....	AR 311 4675
(.084).....	59 01-10.....	AR 311 2015
	59 20-80.....	AR 311 4676
(.085).....	59 01-10.....	AR 310 8473
(.086).....	59 01-10.....	AR 311 2016
	59 20-80.....	AR 311 4677
(.088).....	59 01-10.....	AR 311 2017
	59 20-80.....	AR 311 4678
(.090).....	59 01-10.....	AR 310 8474
	59 20-80.....	AR 311 4679
(.092).....	59 01-10.....	AR 311 2018
	59 20-80.....	AR 311 4680
(.094).....	59 01-10.....	AR 311 2019
	59 20-80.....	AR 311 4681
(.095).....	59 01-10.....	AR 310 8475
(.096).....	59 01-10.....	AR 311 2020
	59 20-80.....	AR 311 4682
(.098).....	59 01-10.....	AR 311 2021
	59 20-80.....	AR 311 4683
(.100).....	59 20-80.....	AR 311 4684

## 9.050 GEAR SET, Rear Axle Ring

GEAR SET (Incl. Pinion)(9/34 Ratio).....	59 01 (WST)(WOD): 59 10 (WST)(WAT).....	1 313 2638
(9/37 Ratio).....	59 01 (WOD): 59 10 (WST)(WOD).....	1 313 0382
(8/35 Ratio).....	59 10 (WST)(WOD).....	1 314 9924
(9/40 Ratio).....	59 20 (WST)(WOD).....	1 315 3083
(13/43 Ratio).....	59 01 (WST)(WOD): 59 10 (WAT).....	1 314 4127
(10/41 Ratio).....	59 20-80 (WST)(WOD).....	1 315 0114
(11/39 Ratio).....	59 20 (WAT): 59 80 (WST)(WOD).....	1 315 3085
(13/41 Ratio).....	59 20-80 (WAT).....	1 315 3081
(15/43 Ratio).....	59 80 (LLD-WAT).....	1 315 6025
NUT, Pinion.....	59 01-10.....	1 310 5331
	59 20-80.....	1 315 4105
WASHER, Pinion Nut.....	59 01-10.....	1 313 0372
	59 20-80.....	1 315 4152
Lock.....	59 01-10.....	1 313 0373
	59 20-80.....	1 315 4151
SCREW, To Case.....	59 20-80.....	8 314 7576
(8/35 And 9/37 Ratios).....	59 01-10.....	8 314 7576
(9/34 And 13/43 Ratios).....	59 01-10.....	8 314 7577

## 9.052 BEARING, Rear Axle Pinion

BEARING (Front).....	59 01-10.....	1 310 5340
	59 20-80.....	1 98 553
(Rear).....	59 01-10.....	1 310 5338
	59 20-80.....	1 98 555

## 9.055 CUP, Rear Axle Pinion Bearing

CUP (Front).....	59 01-10.....	1 310 5341
	59 20-80.....	1 98 552



# AMERICAN MOTORS PARTS CATALOG

9.068

(Rear).....	59 01-10.....	1	310 5339
	59 20-80.....	1	98 554

**9.057 SHIM SET, Rear Axle Pinion Adjusting**

SHIM SET (Incl. 1 Each Of .003, .005, .007, .010 And .020).....	59 01-10.....	AR	320 2345
(Incl. 1 Each Of .003, .005, .007 And .010).....	59 20-80.....	AR	320 2346
SHIM (.003).....	59 01-10.....	AR	314 4245
	59 20-80.....	AR	314 4170
(.005).....	59 01-10.....	AR	314 4246
	59 20-80.....	AR	314 4171
(.007).....	59 01-10.....	AR	314 4483
	59 20-80.....	AR	314 4484
(.010).....	59 01-10.....	AR	314 4247
	59 20-80.....	AR	314 4172
(.020).....	59 01-10.....	AR	314 4248

**9.062 SHIM, Rear Axle Pinion Shaft Bearing**

SHIM (.003).....	59 20-80.....	AR	98 530
(.010).....	59 20-80.....	AR	98 532
(.053).....	59 01-10.....	AR	311 3873
	59 20-80.....	AR	311 4619
(.054).....	59 01-10.....	AR	311 3874
	59 20-80.....	AR	311 4620
(.056).....	59 01-10.....	AR	311 3875
	59 20-80.....	AR	311 4621
(.058).....	59 01-10.....	AR	311 3876
	59 20-80.....	AR	311 4622
(.059).....	59 01-10.....	AR	311 3877
	59 20-80.....	AR	311 4623
(.063).....	59 01-10.....	AR	311 3878
	59 20-80.....	AR	311 4624
(.064).....	59 01-10.....	AR	311 3879
	59 20-80.....	AR	311 4625
(.066).....	59 01-10.....	AR	311 3880
	59 20-80.....	AR	311 4626
(.068).....	59 01-10.....	AR	311 3881
	59 20-80.....	AR	311 4627
(.069).....	59 01-10.....	AR	311 3882
	59 20-80.....	AR	311 4628

**9.064 SEAL, Rear Axle Pinion Oil**

SEAL.....	59 01.....	1	312 8171
	59 10.....	1	313 8143
	59 20-80.....	1	315 3825
RETAINER.....	59 10.....	1	313 8144
	59 20-80.....	1	315 0112
GASKET.....	59 10.....	1	314 9899
	59 20-80.....	1	312 3593

**9.068 SHAFT, Rear Axle Drive**

SHAFT.....	59 01.....	2	315 4254
	59 10.....	2	315 3151



# AMERICAN MOTORS PARTS CATALOG

(Left).....	59 20.....	1	315 3157
	59 80.....	1	315 3155
(Right).....	59 20.....	1	315 3158
	59 80.....	1	315 3156
NUT, To Hub.....	59 01-10-20-80.....	2	315 5675
WASHER, To Hub.....	59 01-10-20-80.....	2	18 737
PIN, To Hub Nut.....	59 01-10-20-80.....	2	G103387
 9.072 SEAL, Rear Axle Drive Shaft Inner Oil			
SEAL.....	59 01-10.....	2	315 0548
	59 20-80.....	2	315 0815
 9.073 BEARING, Rear Axle Drive Shaft			
BEARING.....	59 01-10.....	2	314 1139
	59 20-80.....	2	315 0046
 9.075 CUP, Rear Axle Drive Shaft			
CUP.....	59 01-10.....	2	314 3329
	59 20-80.....	2	315 0045
 9.076 RETAINER, Rear Axle Drive Shaft Grease			
RETAINER.....	59 20-80.....	2	315 0075
 9.077 SEAL, Rear Axle Drive Shaft Outer Oil			
SEAL.....	59 01-10.....	2	314 8513
(Incl. Retainer).....	59 20-80.....	2	315 0078
RETAINER.....	59 01-10.....	2	315 1345
 9.086 BUMPER, Rear Axle			
BUMPER.....	59 01.....	2	313 0052
	59 18-28-83-88 (LAS): 59 15-19-25-29-85-89...	2	314 4957
	59 18-28-83-88 (WAS).....	2	315 5399
SCREW.....	59 01-10-20-80.....	4	G172475
 9.089 BRACKET, Rear Axle Sway Stabilizer			
BRACKET (On Rear Axle).....	59 10.....	1	314 4993
	59 20-80.....	1	315 6099
NUT, To Axle.....	59 10-20-80.....	1	G124634
WASHER (Plain).....	59 10-20-80.....	1	800 0203
(Lock).....	59 10-20-80.....	1	G120898
(Bite).....	59 10-20-80.....	1	312 5060
 9.090 STABILIZER, Rear Axle Sway			
STABILIZER.....	59 10-20-80.....	1	315 0175
GROMMET.....	59 10-20-80.....	4	312 4400
SPACER, To Body Bracket.....	59 10-20-80.....	2	313 6080
SCREW, To Body Bracket (On Side Sill).....	59 10-20-80.....	1	314 5050
(On Rear Axle).....	59 10-20-80.....	1	G271751
WASHER (Lock), To Body Bracket Screw.....	59 10-20-80.....	2	G121574
NUT, To Body Bracket.....	59 10-20-80.....	2	G121358



# AMERICAN MOTORS PARTS CATALOG

9.105

## 9.092 ROD, Rear Axle Sway Stabilizer Bracket Support

ROD.....	59 18-28-80.....	1	315 6672
SCREW (At Bracket).....	59 18-28-80.....	1	G181668
WASHER (Bite)(At Tank).....	59 18-28-80.....	1	310 8995
(Lock)(At Bracket).....	59 18-28-80.....	1	G131100
NUT (At Bracket).....	59 18-28-80.....	1	G120370

## 9.100 SHAFT, Propeller

SHAFT.....	59 01 (WST).....	1	315 4263
	59 01 (WOD).....	1	315 4262
	59 01 (WAT).....	1	315 4661
	59 10 (WST).....	1	311 9150
	59 10 (WOD).....	1	311 9151
	59 10 (WAT).....	1	315 2911
	59 10 (WST-Heavy Duty-Note 9.140-1).....	1	315 5762
	59 20 (WST)(WOD).....	1	315 3715
	59 20 (WAT).....	1	315 3605
	59 80 (WST)(WOD).....	1	315 3716
	59 80 (WAT).....	1	315 6291

## 9.101 COUPLING, Propeller Shaft

COUPLING.....	59 10 (WST)(WOD).....	1	313 8142
	59 20-80.....	1	315 3585
(Incl. Shield And Nut).....	59 01.....	1	312 9564
SEAL, Oil.....	59 10 (WST)(WOD).....	1	313 8146
	59 20-80.....	1	315 3601
RETAINER, Oil Seal.....	59 10 (WST)(WOD).....	1	313 8147
	59 20-80.....	1	315 3602
SPACER, Shaft To Pinnion.....	59 10 (WST)(WOD).....	1	313 8466
	59 20-80.....	1	315 3078

## 9.104 YOKE, Universal Joint

YOKE.....	59 10 (WAT).....	1	320 0536
	59 10 (WST-Heavy Duty-Note 9.140-1).....	1	320 1561
	59 20 (WAT).....	1	320 0852
	59 80 (WAT).....	1	320 0853
(Front).....	59 01 (WST).....	1	311 5781
	59 01 (WOD).....	1	311 5780
	59 01 (WAT).....	1	320 0934
(Rear).....	59 01.....	1	311 6957

## 9.105 JOINT, Universal

JOINT.....	59 10 (WST)(WOD).....	1	314 5473
	59 20 (WST)(WOD).....	1	313 8316
	59 80 (WST)(WOD).....	1	315 6293



# AMERICAN MOTORS PARTS CATALOG

## 9.107 SPIDER, Universal Joint

SPIDER.....	59 01 (2 Req.): 59 10 (WAT)(1 Req.).....	AR 320 0854
	59 10 (WST)(WOD).....	1 311 9752
	59 80.....	1 320 0856
(1" O.D. Bearing).....	59 10 (WST-Heavy Duty-Note 9.140-1): 59 20...	1 320 0855
(1-1/16" O.D. Bearing).....	59 20 (WST)(WOD).....	1 311 4708

## 9.112 WASHER - SEAL, Universal Joint Bearing

WASHER (1-1/16" O.D. Bearing).....	59 20 (WST)(WOD).....	4 311 4728
SEAL (Neoprene).....	59 10 (WST)(WOD).....	4 320 2275

## 9.118 RETAINER, Universal Joint Round Bearing

RETAINER.....	59 10 (WST)(WOD).....	4 311 9754
	59 80.....	4 311 9733
(1" O.D. Bearing).....	59 01: 59 10 (WAT): 59 10 (WST-Heavy Duty- Note 9.140-1): 59 20.....	4 310 8182
(1-1/16" O.D. Bearing).....	59 20 (WST)(WOD).....	4 311 4716

## 9.134 ROD, Rear Axle Truss

ROD (Left).....	59 10-20-80.....	1 315 0241
(Right).....	59 10-20-80.....	1 315 0242
SCREW, To Torque Tube.....	59 10-20-80.....	1 G181729
Bracket To Axle.....	59 10-20-80.....	4 G181697
WASHER (Lock), To Torque Tube Screw.....	59 10-20-80.....	1 G120898
Bracket To Axle Screw.....	59 10-20-80.....	4 G120384
(Bite), To Torque Tube Screw.....	59 10-20-80.....	3 312 5060
NUT, To Axle Screw.....	59 10-20-80.....	4 G120371

## 9.140 TUBE, Torque

TUBE.....	59 10 (WST).....	1 315 3376
	59 10 (WOD).....	1 315 3377
	59 10 (WAT).....	1 315 6277
	59 10 (WST-Heavy Duty-Note 9.140-1).....	1 315 5753
	59 20 (WST)(WOD).....	1 315 6278
	59 20 (WAT).....	1 315 6279
	59 80 (WST)(WOD).....	1 315 6280
	59 80 (WAT).....	1 315 6281

## 9.144 BEARING KIT, Propeller Shaft

BEARING KIT (Incl. Lock Ring).....	59 10 (WST)(WOD).....	1 311 6741
	59 20-80 (WST)(WOD).....	1 311 5751
RING, Lock.....	59 10 (WST)(WOD).....	1 313 3653
	59 20-80 (WST)(WOD).....	1 312 7812
RETAINER, Bearing.....	59 20-80.....	1 312 3590

NOTE 9.140-1: 59 10 (WST) Cars having a production installed Heavy Duty Package may be identified in the following way: The Trunnion at the Transmission End of the Torque Tube is Welded, instead of Threaded to the Torque Tube.



# AMERICAN MOTORS PARTS CATALOG

9.156

## 9.146 TRUNNION, Torque Tube

TRUNNION.....	59 10 (WST)(WOD).....	1	313 5186
Kit.....	59 10 (WST-Heavy Duty-Note 9.140-1):		
	59 10 (WAT): 59 20-80.....	1	311 7235
BOOT (Rubber).....	59 10 (WST)(WOD).....	1	313 6949
OILER.....	59 10 (WST)(WOD).....	1	G271285
BOLT.....	59 10 (WST)(WOD).....	1	310 5515
NUT, Bolt.....	59 10 (WST)(WOD).....	1	G119252
PIN, Cotter.....	59 10 (WST)(WOD).....	1	G103373

## 9.148 STUD - SCREW, Torque Tube Trunnion

STUD.....	59 10 (WST)(WOD).....	2	310 6425
To Rear Axle.....	59 10-20-80.....	6	312 1398
SCREW, To Transmission.....	59 10 (WAT): 59 10 (WST-Heavy Duty- Note 9.140-1): 59 20-80.....	6	G181639
WASHER (Plain), To Trans. Screw.....	59 10 (WAT): 59 10 (WST-Heavy Duty- Note 9.140-1): 59 20-80.....	6	800 0163
(Lock), Stud.....	59 10 (WST)(WOD).....	2	G103328
To Trans. Screw.....	59 10 (WAT): 59 10 (WST-Heavy Duty- Note 9.140): 59 20-80.....	6	G120382
To Rear Axle Stud.....	59 10-20-80.....	6	G103328
NUT, Stud.....	59 10 (WST)(WOD).....	2	G103027
Screw.....	59 10 (WAT): 59 10 (WST-Heavy Duty- Note 9.140-1): 59 20-80.....	6	G120369
To Rear Axle Stud.....	59 10-20-80.....	6	G103027
Trunnion Stud.....	59 10 (WST)(WOD).....	2	G442834
Pal.....	59 10 (WST)(WOD).....	2	G107354

## 9.150 CUSHION, Torque Tube To Adapter

CUSHION.....	59 10 (WST)(WOD).....	4	312 6205
RETAINER, To Tube (Inner).....	59 10 (WST)(WOD).....	4	312 6206
(Outer).....	59 10 (WST)(WOD).....	4	312 6207
SPACER, To Tube.....	59 10 (WST)(WOD).....	2	312 6595

## 9.152 SEAL, Torque Tube

SEAL.....	59 10.....	1	313 8143
	59 20-80.....	1	315 3825
RETAINER.....	59 10.....	1	313 8144
	59 20-80.....	1	315 0112
GASKET.....	59 10.....	1	314 9899
	59 20-80.....	1	312 3593

## 9.156 ADAPTER, Torque Tube

ADAPTER.....	59 10 (WST).....	1	314 5082
	59 10 (WOD).....	1	314 5358
	59 10 (WST-Heavy Duty-Note 9.140-1):		
	59 20 (WST).....	1	313 2500
	59 20 (WOD).....	1	312 6144
	59 80 (WST)(WOD).....	1	315 0675



# AMERICAN MOTORS PARTS CATALOG

GASKET.....	59 10 (WST).....	1	314 2756
	59 10 (WST-Heavy Duty-Note 9.140-1):		
	59 20 (WST)(WOD).....	1	311 3242
	59 80 (WST)(WOD).....	1	315 0676
SCREW.....	59 10 (WST).....	3	G179857
	59 10 (WST).....	1	G179863
	59 10-20 (WOD).....	4	G179861
	59 10 (WST-Heavy Duty-Note 9.140-1):		
	59 20 (WST).....	1	G179839
	59 80 (WST)(WOD).....	4	G179860
WASHER (Plain), Screw.....	59 10 (WST).....	1	314 2758
	59 10 (WST-Heavy Duty-Note 9.140-1):		
	59 20 (WST).....	1	314 2761
(Lock), Screw.....	59 10-20 (WST).....	3	G114607
	59 10 (WST-Heavy Duty-Note 9.140-1):		
	59 10-20 (WOD): 59 80 (WST)(WOD).....	4	G114607

9.160 SEAL, Universal Joint

SEAL.....	59 10 (WST-Heavy Duty-Note 9.140-1):		
	59 10-20 (WST)(WOD).....	1	310 5459
	59 80 (WST)(WOD).....	1	315 0677